

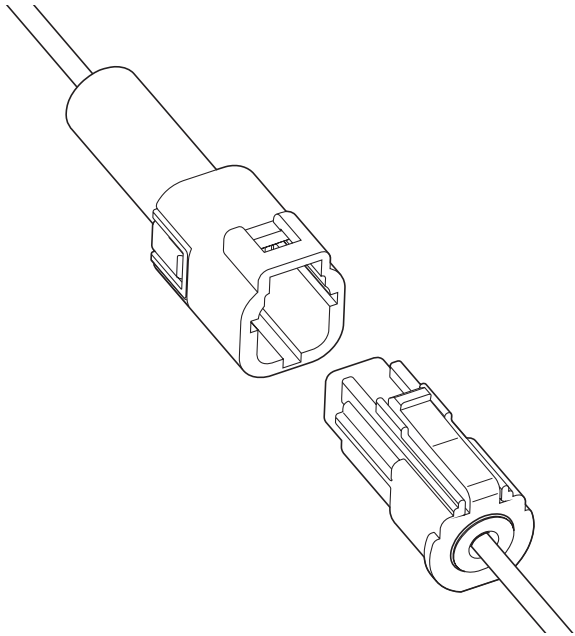

WPK CONNECTOR

Disconnectable Crimp style Wire-to-wire connectors



This connector is compact and excels in waterproof and durability. This wire-to-wire connector can be used for the place of which especially waterproof is required. Its waterproof grade is 7 ingress protection of JIS C 0920 (IEC 60529 IPX7).

- **Waterproof performance**
- **Contained seal ring**
- **Proven contact configuration**
- **Inner-housing lock**
- **Compact design**

Specifications

- Current rating: 7A AC, DC (0.85mm²)
 - Voltage rating: 12V AC, DC
 - Temperature range: -40°C to +105°C
(including temperature rise in applying electrical current)
 - Contact resistance: Initial value/5m Ω max.
After environmental testing/10m Ω max.
 - Insulation resistance: 100M Ω min.
 - Withstanding voltage: 1,000V AC/minute
 - Applicable wire: 0.5 to 0.85mm²
Insulation O.D./1.6 to 1.9mm
 - Waterproof grade: Grade 7 ingress protection of JIS C 0920
(IEC 60529 IPX7)
- * Compliant with RoHS.
* Refer to "General Instruction and Notice when using Terminals and Connectors" at the end of this catalog.
* Contact JST for details.

Assembly layout

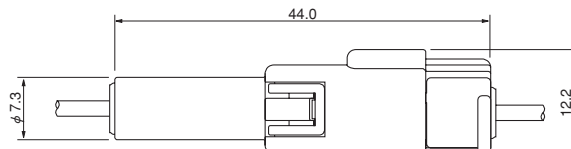

WPK CONNECTOR

Terminal

Male terminal

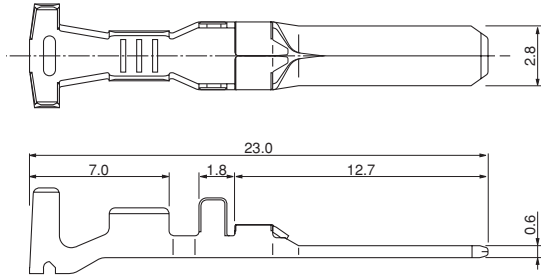

Female terminal

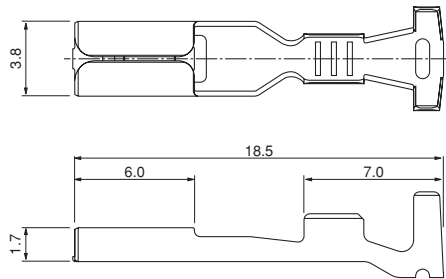

| Model No. | | Applicable wire (mm ²) | Insulation O.D. (mm) | Q'ty / reel |
|----------------------|----------------------|---------------------------------------|-------------------------|----------------|
| Male terminal | Female terminal | | | |
| SWPKP-21T-0.6 | SWPKR-21T-0.6 | 0.5~0.85 | 1.6~1.9 | 3,000 |

Material and Finish

Copper alloy, tin-plated (reflow treatment)

RoHS compliance

| Terminal | Crimping machine | Applicator | | |
|----------------------|---------------------|------------------|------------------|----------------------------|
| | | Crimp applicator | Dies | Crimp applicator with dies |
| SWPKP-21T-0.6 | AP-K2N | MKS-L | MK/SWPKP/R-21-06 | APLMK SWPKP/R21-06 |
| | | — | — | — |
| SWPKR-21T-0.6 | — | MKS-L | MK/SWPKP/R-21-06 | APLMK SWPKP/R21-06 |
| | | — | — | — |

Housing

Material: PBT, black

| Circuit | Voltage rating | Current rating | Male housing(for male terminal) | Female housing(for female terminal) |
|---------|-------------------|-------------------|---------------------------------|-------------------------------------|
| 1 | 12V | 7A | 01P-WPKH-KN | WPKR-01H-K |
| | | | Q'ty / box 100 | Q'ty / box 1,000 |

RoHS compliance

Wire end seal

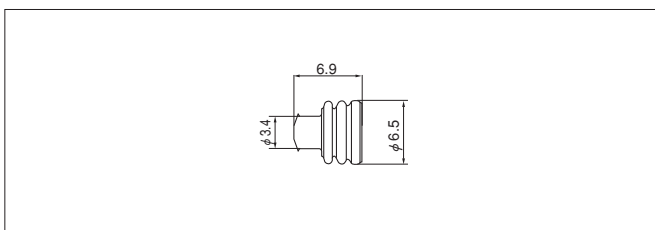

| Model No. | Rubber inner diameter (mm) | Insulation O.D. (mm) | Q'ty / bag |
|------------------|----------------------------|----------------------|------------|
| WPKS-1.3N | 1.3 | 1.6~1.9 | 1,500 |

| Color | Material |
|-------|----------|
| Brown | NBR |

RoHS compliance

Note: Contact JST for applicable wire.