

Antenna 101247



GSM Antenna



Specifications

Frequencies:	AMPS (824-894 MHz) ISM (868 MHz) GSM (900 MHz) DCS (1800 MHz) PCS (1900 MHz) 3G (UMTS 2.1 GHz) WIFI / BLUETOOTH (2.4 GHz)
Impedance:	50 Ohms
Polarization:	Linear
Gain*:	2.2 dBi Avg.
VSWR**:	<2.6:1
Operating temperature:	-40°C to +85°C
IP:	IP67
Cable:	3m RG174 FME (female)



Mechanical Specifications:

Material:	Lid: ABS / Base: Zamak / Gasket: TPE
Dimensions:	77.4mm x 15.9mm (dimensions after mounting)
Weight:	approx. 150 g
Colour:	Black

*Antenna gain depend on size of the ground plane

**SWR stated when measured with 2.5m RG174 on 50x50cm ground-plane

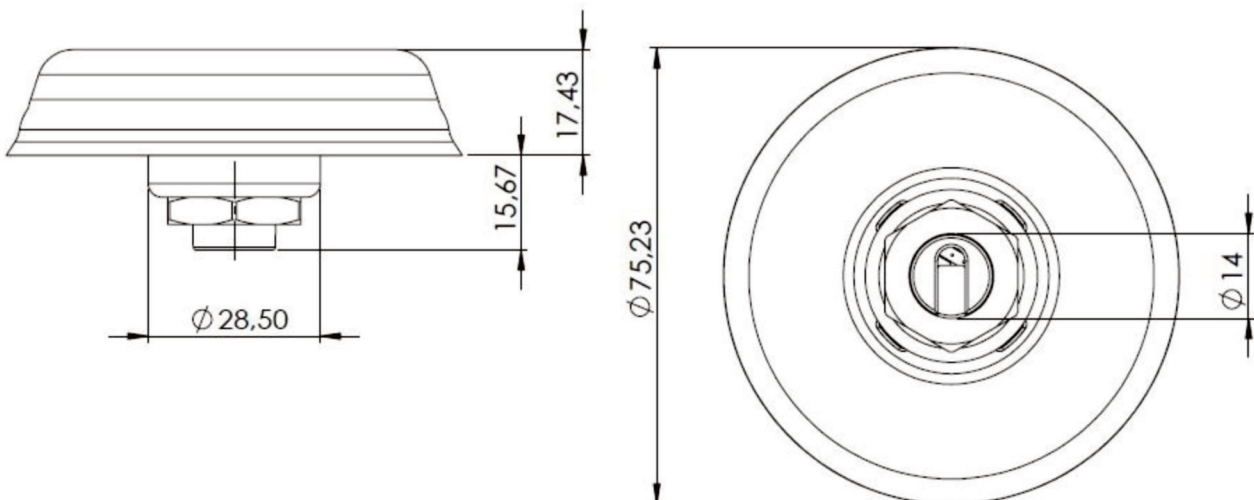

Antenna 101247



GSM Antenna



Log Mag (Penta Band)

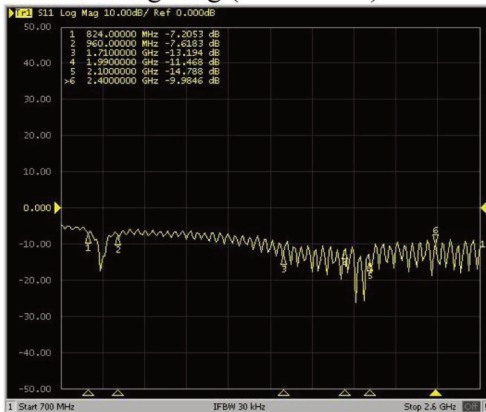

VSWR (Penta Band)

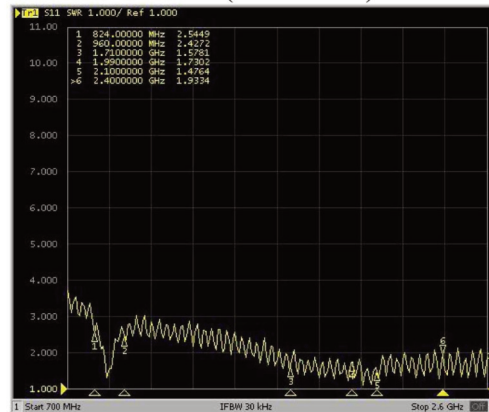

850MHz

Freq = 0.8500GHz Az= 45 EL= 45

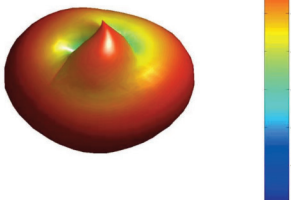

900MHz

Freq = 0.9GHz Az= 45 EL= 45

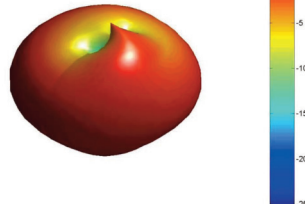

1800MHz

Freq = 1.8GHz Az= 45 EL= 45

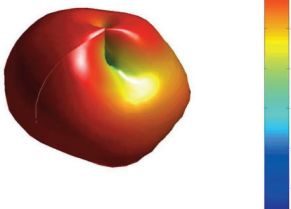

1900MHz

Freq = 1.9GHz Az= 45 EL= 45

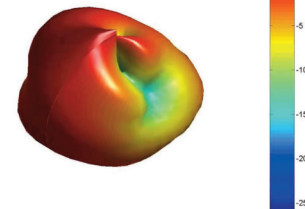

2100MHz

Freq = 2.1GHz Az= 45 EL= 45

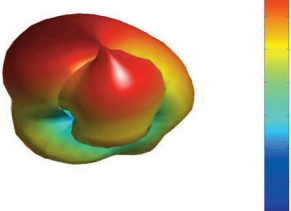

2400MHz

Freq = 2.4GHz Az= 45 EL= 45

