

M2:1

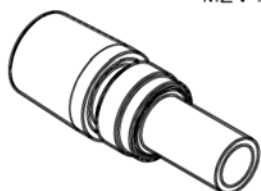

Kabelzuschnitt
Stripping dimension

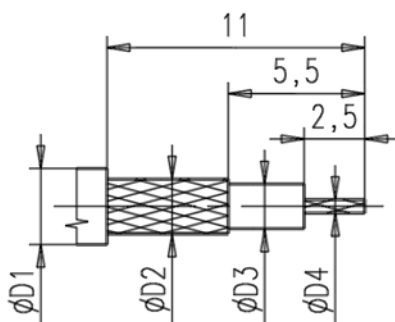

Fuer Kabel /
For cable

Gr.	Type Typ	ØD1 max.	ØD2 max.	ØD3 max.	ØD4 max.	ØD5	ØD6	ØD7	ØD8	Crimp Aussen/out	Crimp Innen/in
1	RG 178 BU;RG 196 AU;	2,10	1,30	0,84	0,30	1,15	1,70	2,50	4,00	3,25	0,70
2	RG 174 BU; RG 188AU; RG 316 U; (C)	2,80	2,24	1,67	0,54	1,70	2,30	3,00	4,00	3,25	0,70
3											
4											
5	RG 316 U-d; K02252d	3,05	2,50	1,55	0,54	1,70	2,30	3,30	4,00	3,25	0,70

IMC CONNECTOR SYSTEMS GMBH

general tolerance
ISO 2768
mH

scale: 5:1

Assembly instruction: M43
Stripping dimension: K3

330/00	c	Kabeltabelle geae	08.05.00	Sta.		date	name
329/96	b	Ueberarbeitet	08.05.00	Sta.	generate	25.07.96	Schuh
	a		08.05.00	Sta.	checked		
					Norm		
					24966		

Kabelbuchse
Cable mount jack



1071301

Rev.
C

nr. rev. alteration date name