

Antenna 194876



4G LTE Adhesive Mount Antenna



Technical Data:

Frequency:	698-960 / 1710-2170 / 2500-2700 MHz
Polarisation:	linear
Gain max.:	4.0 dBi
VSWR:	1.3:1 / 1.4:1
Impedance:	50 Ohm
Dimensions:	116 x 22 x 6.7 mm
Operating Temperature:	-40°C to +85°C
Colour:	Black
Radome:	PC/ABS UV Stable
Mounting:	Adhesive Mount
Cable:	2 m LL100
Connector:	Fakra D (f) R/A

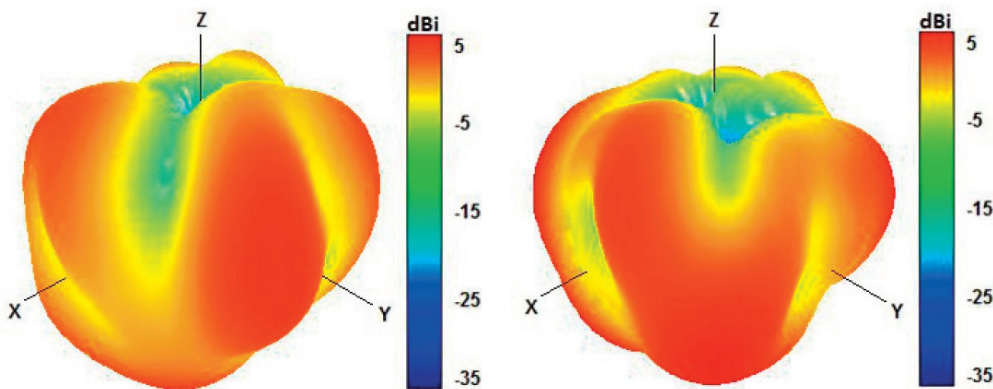
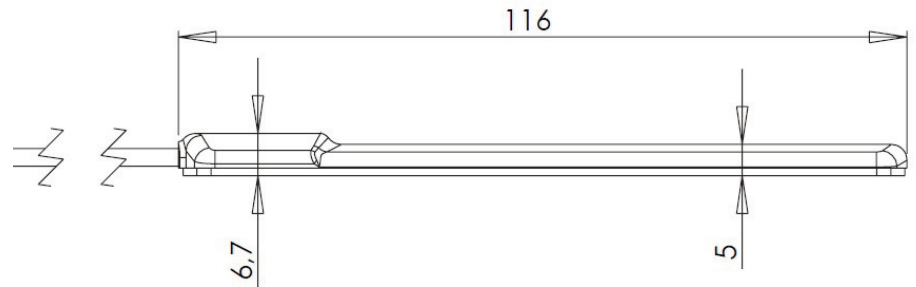

750 and 850 MHz Radiation pattern

Antenna
194876



4G LTE Adhesive Mount Antenna

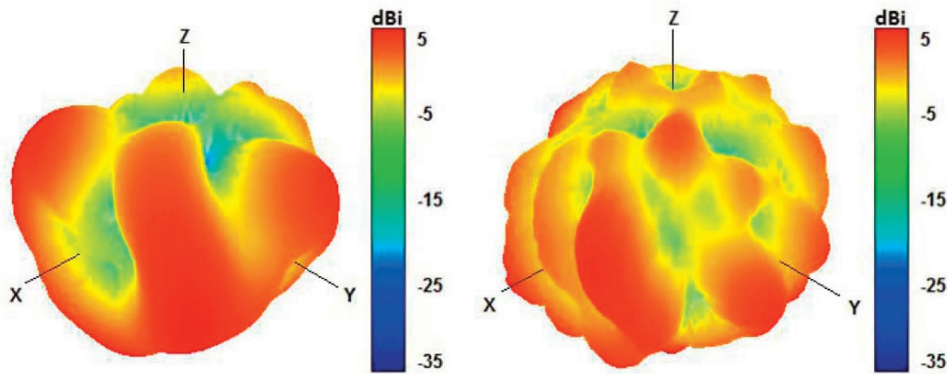

940 and 1750 MHz Radiation pattern

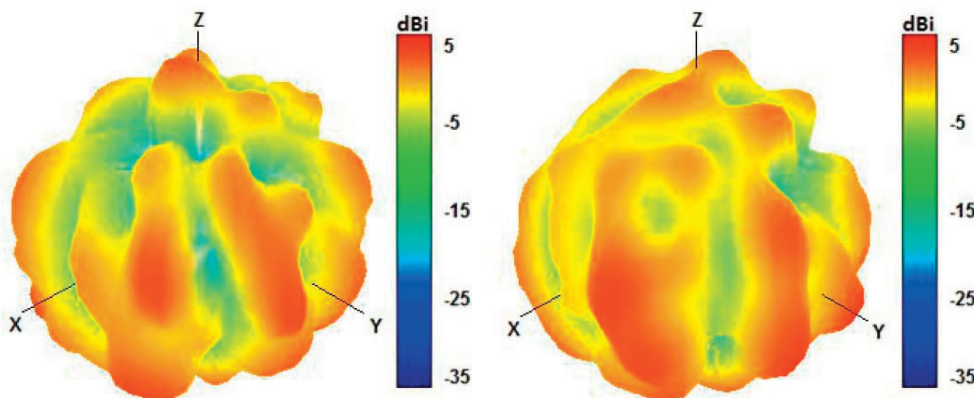

1850 and 1950 MHz Radiation pattern

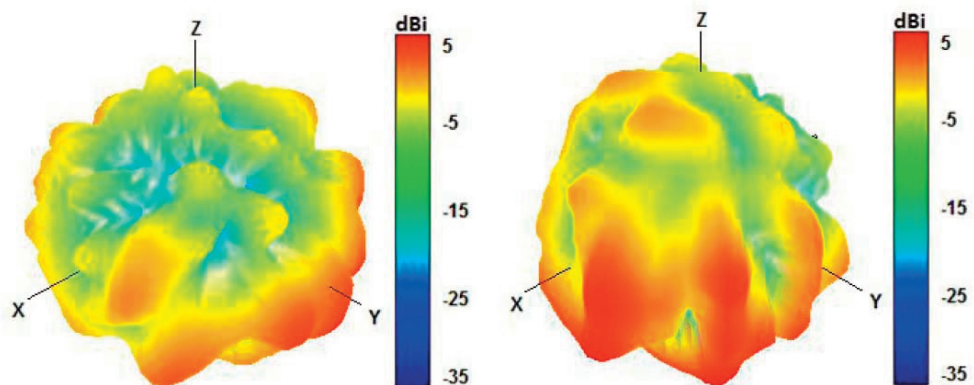

2100 and 2600 MHz Radiation pattern